



Hunter's 350 Series fan Controller 3.5" color digital touchscreen is a simple and straightforward way to manage your facility's comfort over an Ethernet based network.

No power needed as this control receives power from the VFD directly. (POE) Power over ethernet.

Designed to work 1:1 fan

Compatible with models:
TITAN & ECO & RM & XP



Hunter's 350HMI series
Fan Controller

- ✓ Manage all basic fan operations:
 1. On/Off.
 2. Winter & Summer.
 3. 0-10 Speed control
- ✓ Proximity sensor to wake controller.
- ✓ Fan fault notification on screen
- ✓ Quick install. POE - power over ethernet.
- ✓ 8-year Warranty



Hunter's 500HMI series
5" PCAP touchscreen Fan Controller

- ✓ Manage all basic fan operations: On/Off. Winter & Summer. 10 Speeds
- ✓ Control up to 30 fans over ethernet based network.
- ✓ Password protection. User schedule and grouping.
- ✓ Create zones, fan naming and individual (IP) fan control.
- ✓ Proximity sensor to wake controller.
- ✓ Fan fault notification on screen. Troubleshoot fan. Reset command.
- ✓ Quick install. POE - power over ethernet.
- ✓ Compatible with BMS integration with optional BACnet gateway.
- ✓ 8-year Warranty

Operating the Fan or Zone

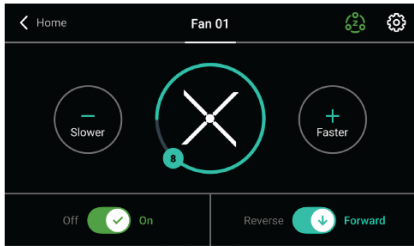

Fan control page

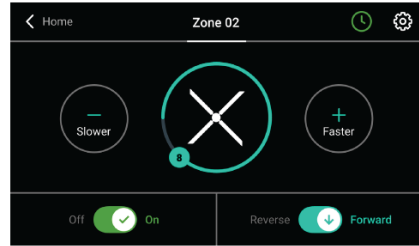

Zone control page

All actions for operating a fan, or all fans in a zone, are the same.

Scheduling a Fan or Zone

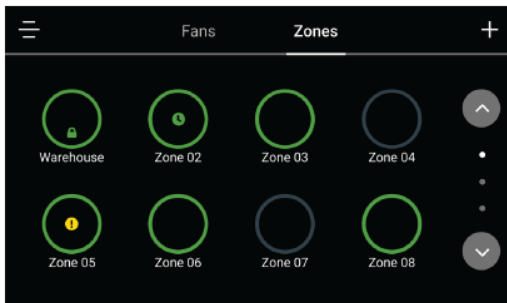

Zone Home Page



Schedule Zone operation

- ✓ A fan or a zone is able to have three (3) scheduled Actions of operation per day.
- ✓ An Action = start, stop, or a change in fan(s) speed or direction.
- ✓ Select the day of the week the fan or zone is to perform the scheduled Action.
- ✓ Select the fan Action: on/off, forward/reverse.
- ✓ Set the start time desired for the fan(s) Action to begin.
- ✓ Set the desired fan(s) speed for the scheduled time.

The fan(s) will now follow this scheduled operation until the next Action is scheduled to begin.

- Scheduling a single fan requires including the fan into a zone, and then scheduling the zone.
- Fans must be unlocked to modify schedules or zones.



Hunter's 700HMI series with environmental control package 7" PCAP touchscreen Fan Controller

The 700HMI controller can manage up to 30 fans using both temperature and humidity levels to simplify getting the most from the facility's HVLS fans.

Same 500HMI features + environmental control software integrated.

Most efficient way to run a facility's fans. Automatic configuration. Quick install, no additional power necessary. 1-Touch Seasonal Adjust. (additional zone to install 2x sensors)

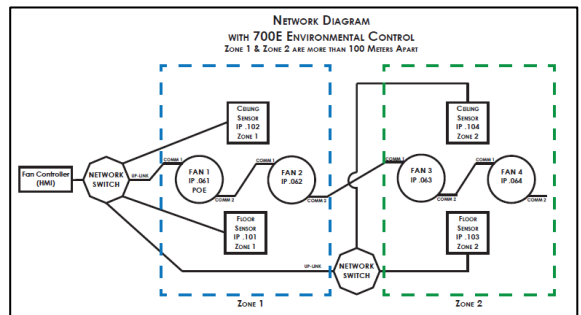
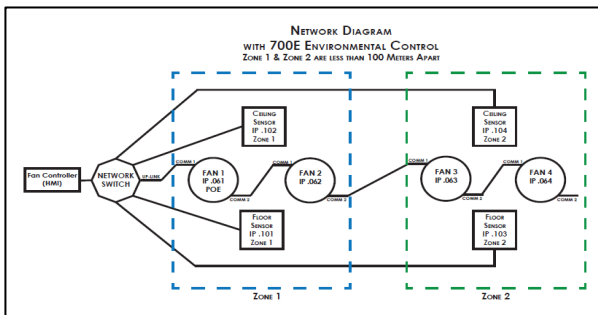

Environmental control

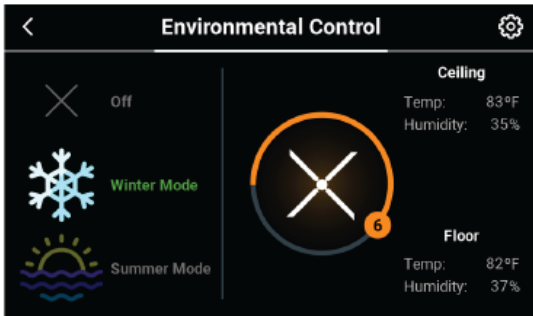

Winter mode page

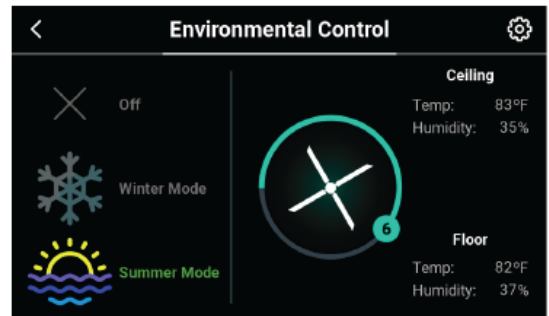

Summer mode page

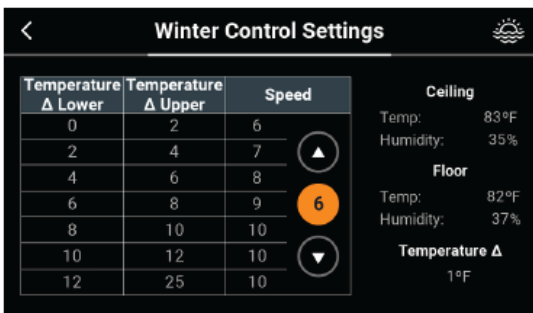

Winter default setting is based on air destratification. **Lighter hot air rises to the ceiling space as surrounding heavy cooler air falls to the floor space.**

With the help of high-volume airflow set in the fan's reverse direction, hot air can circulate and mix with cooler air to the floor level. Speed 6 in reverse is equivalent to Speed 3 in the forward direction due to mechanical limitation.

For every two-degree temperature delta, the speed is incremented/decremented by 1. The default starting speed is 6 in reverse direction.

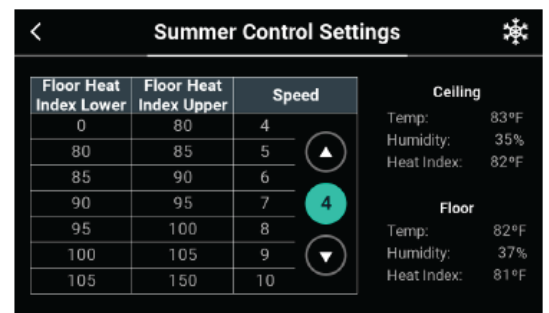

Summer default setting is based on heat index.

The heat index is calculated from the sensor's temperature and relative humidity reading at the floor / occupancy level.

With the help of high-volume airflow in forward direction, air mixing including humidity, can be established to create a more comfortable environment.

For every 5 Heat Index units, the fan speed is incremented / decremented by 1 speed. The default starts at speed 4 in forward direction.



BACnet Gateway Building Management System Solutions

- ✓ Gateway allows the Fan Network to communicate to both a BAS/BMS and maintain a local HMI controller.
- ✓ Status of fan is the same at the BAS and the local HMI controller.
- ✓ (1) Gateway per network (30 fans maximum)
- ✓ Remote monitoring, control and visualization of fan network.
- ✓ Support BACnet MS/TP and BACnet/IP

